

RECORD OF SURVEY

A PORTION OF SECTION 20, T. 20 N., R. 15 E., W.M.,
KITTITAS COUNTY, WASHINGTON

EXISTING LEGAL DESCRIPTIONS PER CHICAGO TITLE COMPANY GUARANTEE NO. 72156-45618054

PARCEL 1:

TRACT CC-1A OF THAT CERTAIN SURVEY AS RECORDED JUNE 15, 2009, IN BOOK 36 OF SURVEYS, PAGES 120 AND 121, UNDER AUDITOR'S FILE NO. 200906150001, RECORDS OF KITTITAS COUNTY, WASHINGTON; BEING A PORTION OF TRACTS CC-1, G-2, G-5 AND S-2, OF SUNCADIA PHASE I, DIVISION 3, IN THE COUNTY OF KITTITAS, STATE OF WASHINGTON, AS PER PLAT THEREOF RECORDED IN BOOK 9 OF PLATS, PAGES 94 THROUGH 120, IN THE COUNTY OF KITTITAS, STATE OF WASHINGTON.

PARCEL 2:

TRACTS G-2A AND G-5A OF THAT CERTAIN SURVEY RECORDED JUNE 19, 2009, IN BOOK 36 OF SURVEYS, PAGES 120 AND 121, UNDER AUDITOR'S FILE NO. 200906150001, BEING A PORTION OF TRACTS CC-1, G-2, G-5, AND S-2, OF SUNCADIA PHASE I, DIVISION 3, IN THE COUNTY OF KITTITAS, STATE OF WASHINGTON, AS PER PLAT THEREOF RECORDED IN BOOK 9 OF PLATS, PAGES 94 THROUGH 120, IN THE COUNTY OF KITTITAS, STATE OF WASHINGTON.

AND

TRACT S-2A OF THAT CERTAIN SURVEY AS RECORDED JUNE 15, 2009, IN BOOK 36 OF SURVEYS, PAGES 120 AND 121, UNDER AUDITOR'S FILE NO. 200906150001, RECORDS OF KITTITAS COUNTY, WASHINGTON; BEING A PORTION OF TRACT S-2, OF SUNCADIA PHASE I, DIVISION 3, IN THE COUNTY OF KITTITAS, STATE OF WASHINGTON, AS PER PLAT THEREOF RECORDED IN BOOK 9 OF PLATS, PAGES 94 THROUGH 120, IN THE COUNTY OF KITTITAS, STATE OF WASHINGTON.

LINE TABLE		
LINE #	DIRECTION	DISTANCE
L1	N 56°10'04" W	104.57'
L2	N 60°45'15" W	92.30'
L3	S 75°07'19" W	81.90'
L4	S 58°39'29" W	58.76'
L5	S 10°41'48" W	145.34'
L6	S 11°05'44" W	161.33'
L7	S 33°07'38" E	86.54'
L8	S 87°08'17" W	79.55'
L9	N 51°10'25" W	296.65'
L10	N 28°16'09" W	42.73'
L11	N 31°27'52" W	127.22'
L12	N 56°16'50" W	114.28'
L13	S 79°32'34" W	96.96'
L14	N 62°14'34" W	48.88'
L15	N 30°08'52" W	48.12'
L16	N 9°56'42" E	45.90'
L17	N 37°04'38" E	32.57'
L18	N 59°51'40" E	149.50'
L19	N 24°21'03" W	185.96'
L20	N 42°36'36" W	176.09'

LINE TABLE		
LINE #	DIRECTION	DISTANCE
L21	N 81°45'35" W	91.34'
L22	S 68°45'49" W	78.96'
L23	S 39°16'35" W	155.98'
L24	S 15°09'53" W	195.31'
L25	S 75°41'14" W	63.54'
L26	N 72°26'27" W	82.44'
L27	N 63°49'43" W	89.04'
L28	N 59°28'15" W	92.77'
L29	S 41°08'17" W	157.63'
L30	N 45°29'23" E	160.82'
L31	N 37°07'22" W	85.53'
L32	N 13°21'18" W	90.32'
L33	S 82°02'14" W	167.30'
L34	N 16°31'12" W	17.44'
L35	N 52°52'19" E	112.61'
L36	N 7°23'09" E	173.87'
L37	N 23°16'00" W	169.21'
L38	N 78°25'28" W	111.38'
L39	S 73°04'22" W	223.50'
L40	S 82°12'20" W	207.55'

LINE TABLE		
LINE #	DIRECTION	DISTANCE
L41	N 8°51'53" E	75.69'
L42	N 40°04'54" E	72.00'
L43	N 53°22'13" E	70.51'
L44	S 60°18'18" E	96.02'
L45	S 22°18'09" E	239.93'
L46	N 61°42'39" E	121.99'
L47	S 89°24'35" E	111.40'
L48	S 51°43'50" E	98.76'
L49	N 28°00'35" E	245.69'
L50	S 69°14'32" W	22.31'
L51	S 66°15'54" E	123.57'
L52	S 62°22'58" E	67.61'
L53	N 71°27'50" E	124.88'
L54	N 87°01'07" E	45.64'
L55	S 63°56'01" E	96.70'
L56	S 63°52'11" E	85.31'
L57	S 75°14'24" E	164.34'
L58	N 80°47'33" E	83.05'
L59	S 7°31'53" W	159.64'
L60	S 58°46'04" E	269.21'

LINE TABLE		
LINE #	DIRECTION	DISTANCE
L61	S 23°09'13" E	211.65'
L62	S 10°00'04" W	190.72'
L63	S 10°00'04" W	195.00'
L64	S 10°00'04" W	58.15'
L65	S 80°44'04" E	50.87'
L66	S 88°11'29" E	76.29'
L67	S 55°46'18" E	141.23'
L68	S 51°52'29" E	133.58'
L69	S 67°29'05" E	93.28'
L70	S 81°31'08" E	98.36'
L71	S 42°25'38" E	104.76'
L72	S 43°19'55" E	131.03'
L73	N 53°31'14" E	147.59'
L74	N 71°27'51" E	100.00'
L75	N 71°27'51" E	40.00'
L76	N 33°59'24" W	109.36'
L77	N 2°33'02" E	33.64'
L78	N 38°02'33" W	152.74'
L79	N 58°40'09" W	134.67'
L80	S 18°32'09" E	66.72'

LINE TABLE		
LINE #	DIRECTION	DISTANCE
L81	S 18°32'09" E	130.49'
L82	S 18°32'09" E	197.21'

CURVE TABLE			
CURVE #	RADIUS	LENGTH	DELTA
C1	75.00'	213.21'	162°53'03"
C2	150.00'	103.82'	39°39'24"
C3	415.00'	40.95'	5°39'15"
C4	1155.00'	22.98'	1°08'23"
C5	1155.00'	97.78'	4°51'03"
C6	320.00'	149.44'	26°45'26"
C7	187.50'	54.88'	16°46'16"
C8	212.50'	111.58'	30°05'11"
C9	230.00'	35.45'	8°49'48"
C10	480.00'	32.52'	3°52'56"
C11	1225.00'	174.58'	8°09'55"
C12	330.00'	174.43'	30°17'05"

CURVE TABLE			
CURVE #	RADIUS	LENGTH	DELTA
C13	370.00'	100.45'	15°33'17"
C14	270.00'	32.72'	6°56'39"
C15	270.00'	104.16'	22°06'13"
C16	230.00'	61.10'	15°13'17"
C17	170.00'	45.35'	15°17'06"
C18	216.00'	42.86'	11°22'13"
C19	216.00'	116.60'	30°55'48"
C20	1714.00'	55.36'	1°51'02"
C21	1714.00'	152.92'	5°06'43"
C22	330.00'	174.43'	30°17'05"
C23	330.00'	44.37'	7°42'12"

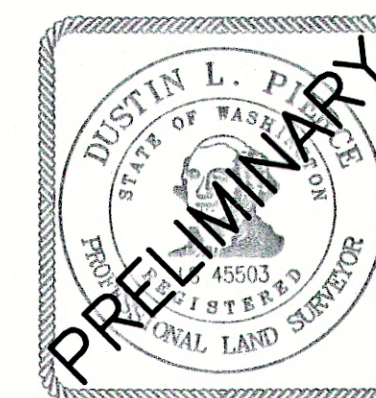

RECEIVED
APR 28 2017
Kittitas County CDS

RECORDER'S CERTIFICATE

FILED FOR RECORD THIS ____ DAY OF ____ 20__ AT ____ M.
IN BOOK ____ OF ____ AT PAGE ____ AT THE REQUEST OF
DUSTIN L. PIERCE
SURVEYOR'S NAME
JERALD V. PETTIT
County Auditor Deputy County Auditor

SURVEYOR'S CERTIFICATE

THIS MAP CORRECTLY REPRESENTS A SURVEY MADE BY ME OR UNDER MY
DIRECTION IN CONFORMANCE WITH THE REQUIREMENTS OF THE SURVEY
RECORDING ACT AT THE REQUEST OF JEFF HANSELL
IN ____ XX ____ 20__ XX ____
DUSTIN L. PIERCE DATE
CERTIFICATE NO. 45503

Encompass
ENGINEERING & SURVEYING

Western Washington Division
165 NE Juniper Street, Suite 201 • Issaquah, WA 98027 • Phone: (425) 392-0250 • Fax: (425) 391-3055
Eastern Washington Division
407 Swiftwater Blvd. • Cle Elum, WA 98922 • Phone: (509) 674-7433 • Fax: (509) 674-7419

BOUNDARY LINE ADJUSTMENT
PREPARED FOR
SWIFTWATER CELLARS/NEW SUNCADIA HOSPITALITY
LOCATED IN SECTION 20
TOWNSHIP 20 NORTH, RANGE 15 EAST. W.M.
KITTITAS COUNTY WASHINGTON

DWN BY <u>DLP</u>	DATE <u>2/2017</u>	JOB NO. <u>131201</u>
CHKD BY <u>GW</u>	SCALE <u>1" = 100'</u>	SHEET <u>3 OF 3</u>